

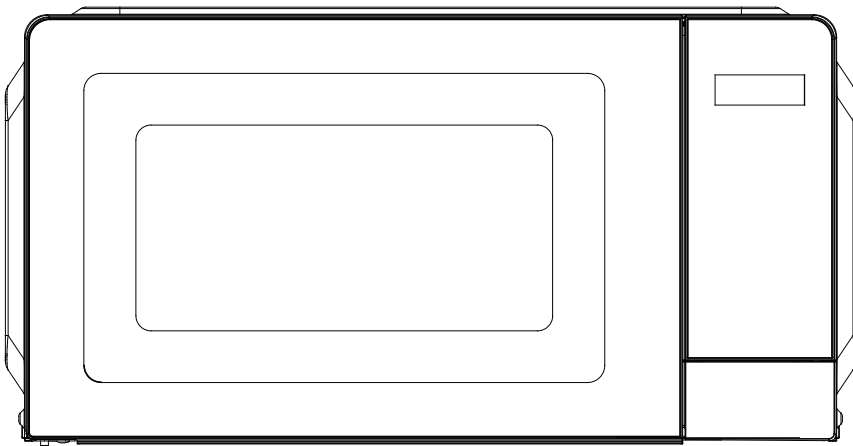

George.
home



**GHMON1171B5G/GHMON1171W5G/
GHMON1171S5G**

17L Digital microwave oven

User Guide

230-240V~ 50Hz, 1100W

IMPORTANT: RETAIN FOR FUTURE REFERENCE



About this guide

We've written this manual to help you get the most from your microwave. Please hold on to it for future reference.

WARNINGS:

THIS PRODUCT WAS DESIGNED AND MANUFACTURED TO MEET STRICT QUALITY AND SAFETY STANDARDS. THERE ARE, HOWEVER, SOME OPERATIONAL PRECAUTIONS YOU SHOULD BE AWARE OF. WARNING!--TO REDUCE THE RISK OF BURNS, ELECTRIC SHOCK, FIRE, INJURY TO PERSONS OR EXPOSURE TO EXCESSIVE MICROWAVE ENERGY:

1. Read all instructions before using the appliance and keep for future reference.
2. Use this appliance only for its intended use as described in the manual. Do not use corrosive chemicals or vapors in this appliance. This type of oven is specifically designed to heat or cook food. It is not designed for industrial or laboratory use.
3. Do not operate the oven when empty.
4. Do not operate this appliance if it has a damaged cord or plug, if it is not working properly, or if it has been damaged or dropped. If the supply cord is damaged, it must be replaced by the manufacturer or its service agent or a similarly qualified person in order to avoid a hazard.
5. To reduce the risk of fire in the oven cavity:



- When heating food in plastic or paper containers, keep an eye on the oven due to the possibility of ignition.
 - Remove wire twist-ties from paper or plastic bags before placing bag in oven.
 - Do not use the cavity for storage purposes. Do not leave paper products, cooking utensils, or food in the cavity when not in use.
 - The microwave oven is intended for heating food and beverages. Drying of clothing and heating of warming pads, slippers, sponges, damp cloth and similar may lead to risk of injury, ignition or fire.
6. **WARNING:** Liquid and other food must not be heated in sealed containers since they are liable to explode.
 7. Microwave heating of beverage can result in delayed eruptive boiling, therefore care has to be taken when handle the container.
 8. Do not fry food in the oven. Hot oil can damage oven parts and utensils and even result in skin burns.
 9. Eggs in their shell and whole hard-boiled eggs should not be heated in microwave ovens since they may explode, even after microwave heating has ended.
 10. Pierce foods with heavy skins such as potatoes, whole squashes, apples and chestnuts before cooking.
 11. The contents of feeding bottles and baby food jars should be stirred or shaken and the temperature should be checked before consumption in order to avoid burns.
 12. Cooking utensils may become hot because of heat transferred from the heated food. Potholders or oven gloves may be needed to handle the utensil.
 13. Only use utensils that are suitable for use in microwave ovens.



14. **WARNING:** It is hazardous for anyone other than a competent person to carry out any service or repair operation that involves the removal of a cover which gives protection against exposure to microwave energy.
15. This appliance is a Group 2 Class B equipment. Group 2 equipment: group 2 contains all ISM RF equipment in which radio-frequency energy in the frequency range 9 kHz to 400 GHz is intentionally generated and used or only used locally, in the form of electromagnetic radiation, inductive and/or capacitive coupling, for the treatment of material, for inspection/analysis purposes, or for transfer of electromagnetic energy. Class B equipment is equipment suitable for use in locations in residential environments and in establishments directly connected to a low voltage power supply network which supplies buildings used for domestic purposes.
16. The microwave oven is only to be used freestanding.
17. **WARNING:** Do not install microwave oven over an oven or hob or other heat-producing appliance.
18. The microwave oven shall not be placed in a cabinet.
19. The door or the outer surface may get hot when the appliance is operating.
20. **Warning:** Accessible parts may become hot during use. Young children should be kept away.
21. During use the appliance becomes hot. Care should be taken to avoid touching any parts inside the microwave oven.
22. The temperature of accessible surfaces may be high when the appliance is operating.
23. The appliance shall be placed against a wall.
24. **WARNING:** If the door or door seals are damaged, the oven must not be operated until it has been repaired by a competent person.



25. This appliance is not intended to be operated by means of an external timer or separate remote-control system.
26. The microwave oven is for household use only and not for commercial use.
27. Please secure the turn table before you move the appliance to avoid damage.
28. The microwave oven is intended for defrosting, cooking and steaming of food only.
29. Use gloves if you remove any heated food.
30. Caution! Steam will escape, when opening lids or wrapping foil.
31. This appliance can be used by children aged from 8 years and above and persons with reduced physical, sensory or mental capabilities or lack of experience and knowledge if they have been given supervision or instruction concerning use of the appliance in a safe way and understand the hazards involved. Children shall not play with the appliance. Cleaning and user maintenance shall not be made by children without supervision.
32. If smoke is observed, switch off or unplug the appliance and keep the door closed in order to stifle any flames.
33. Keep the waveguard cover clean at all times and wipe the interior with a damp cloth after each use. If you leave grease or fat it may overheat, smoke or catch fire.
34. Do not use attachments not recommended by the manufacturer.
35. Do not leave the microwave unattended when in use.
36. Unplug when not in use and before cleaning.
37. The appliance shall not be cleaned with a steam cleaner.



38. The door seals are located around the window and on the inside of the door. The seals are not airtight, but although no microwaves are released it is normal for a small amount of air or steam to escape when the microwave is in use.
39. Please don't dismantle. If a fault occurs have the microwave inspected in a qualified repair shop or return to us at ASDA.
40. ASDA does not recommend allowing children to operate this appliance.
 - The oven should be cleaned regularly and any food deposits removed.
 - Failure to maintain the oven in a clean condition could lead to deterioration of the surface that could adversely affect the life of the appliance and possibly result in a hazardous situation.
 - Metallic containers for food and beverages are not allowed during microwave cooking.
41. A minimum clearance of 7.5cm (3") is required between the microwave and any adjacent wall or surface. Leave a minimum of 30cm(12") above the microwave and NEVER place anything on top as this will block the vents.
42. If the supply cord is damaged, it must be replaced by the manufacturer, its service agent or similarly qualified persons in order to avoid a hazard.
43. Power consumption of standby mode: 0.6 W
Period after which the equipment reaches automatically standby mode: 20 minutes



You should have

Microwave oven, glass tray
and turn table support.

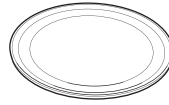
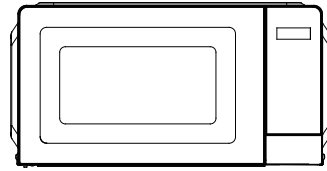



GROUNDING INSTRUCTIONS

This appliance must be grounded. This oven is equipped with a cord having a grounding wire with a grounding plug. It must be plugged into a wall receptacle that is properly installed and grounded. In the event of an electrical short circuit, grounding reduces risk of electric shock by providing an escape wire for the electric current. It is recommended that a separate circuit serving only the oven be provided. Using a high voltage is dangerous and may result in a fire or other accident causing oven damage.

WARNING!--Improper use of the grounding plug can result in a risk of electric shock.

Note:

If you have any questions about the grounding or electrical instructions, consult a qualified electrician or service person.

Neither the manufacturer nor the dealer can accept any liability for damage to the oven or personal injury resulting from failure to observe the electrical connection procedures.

The wires in this cable main are colored in accordance with the following code:

Green and Yellow = EARTH

Blue = NEUTRAL

Brown = LIVE



RADIO INTERFERENCE

Operation of the microwave oven can cause interference to your radio, TV, or similar equipment. When there is interference, it may be reduced or eliminated by taking the following measures:

1. Clean door and sealing surface of the oven.
2. Reorient the receiving antenna of radio or television.
3. Relocate the microwave oven with respect to the receiver.
4. Move the microwave oven away from the receiver.
5. Plug the microwave oven into a different outlet so that microwave oven and receiver are on different branch circuits.

BEFORE CALLING FOR SERVICE

Before asking for service, please check each item below:

- Check to ensure the oven is plugged in securely. If not, remove the plug from the outlet, wait 10 seconds, and plug it in again securely.
- Check for a blown circuit fuse or a tripped main circuit breaker. If these seem to be operating properly, test the outlet with another appliance.
- Check to ensure the control panel is programmed correctly and the timer is set.
- Check to ensure the door is securely closed, engaging the door lock system. If the door is not properly closed, the microwave energy will not flow inside.

IF NONE OF THE ABOVE RECTIFIES THE SITUATION, THEN CONTACT A QUALIFIED TECHNICIAN. DO NOT TRY TO ADJUST OR REPAIR THE OVEN YOURSELF.



COOKING TECHNIQUES

1. Arrange food carefully. Place thickest areas towards outside of dish.
2. Watch cooking time. Cook for the shortest amount of time indicated and add more as needed. Food severely overcooked can smoke or ignite.
3. Cover foods while cooking. Covers prevent spattering and help foods to cook evenly.
4. Turn foods over once during microwave cooking to speed cooking of such foods as chicken and hamburgers. Large items like roasts must be turned over at least once.
5. Rearrange foods such as meatballs halfway through cooking both from top to bottom and from the center of the dish to the outside.

COOKING UTENSILS GUIDE

1. Microwave cannot penetrate metal. Only use utensils that are suitable for use in microwave ovens. Metallic containers for food and beverages are not allowed during microwave cooking. This requirement is not applicable if the manufacturer specifies size and shape of metallic containers suitable for microwave cooking.
2. Microwave cannot penetrate metal, so metal utensils or dishes with metallic trim should not be used.
3. Do not use recycled paper products when microwave cooking, as they may contain small metal fragments which may cause sparks and/or fires.
4. Round /oval dishes rather than square/oblong ones are recommend, as food in corners tends to overcook.
5. Narrow strips of aluminum foil may be used to prevent overcooking of exposed areas. But be careful don' t use too much and keep a distance of 1 inch (2.54cm) between foil and cavity.



How to...

...recognise the parts of your microwave

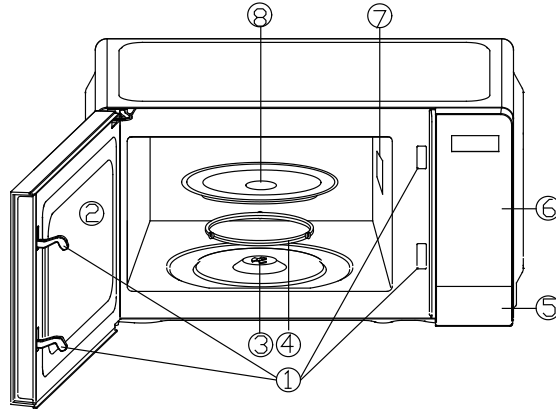

1. Door Safety Lock System
 2. Oven Window
 3. Shaft
 4. Roller Ring
 5. Door Release Button
 6. Control Panel
 7. Wave Guide
 8. Glass Tray
- (Please do not remove the mica plate covering the wave guide)

How to...

...assemble your microwave

1. Remove any tape and place the turntable support in the centre of the recess on the floor of the microwave.
2. Place the glass tray onto the turntable support, aligned with the turntable shaft.

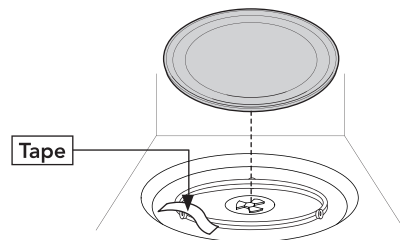



How to...

...recognise the microwave control panel

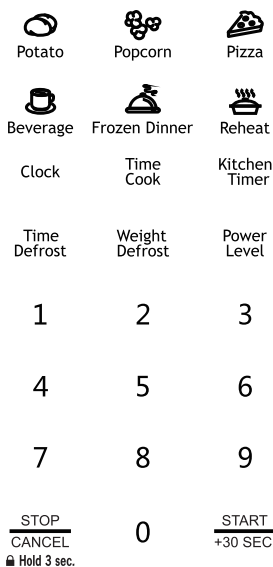

- **DISPLAY SCREEN**

Time, power and indicators are displayed.

- **AUTO COOK MENUS**

Instant settings to cook popular foods

- **CLOCK**

Press to set clock time.

- **TIME COOK**

Press to set microwave cooking program.

- **KITCHEN TIMER**

Press to set timer function.

- **TIME DEFROST**

Press to defrost food based on time.

- **WEIGHT DEFROST**

Press to defrost food based on weight.

- **POWER LEVEL**

Press to set microwave cooking power level.

- **NUMBER BUTTONS (0-9)**

Used to set time or food weight.

- **STOP/CANCEL/Hold 3 sec.**

Press once to temporarily stop cooking, or twice to cancel cooking altogether. It is also used to set child lock.

- **START/+30 SEC.**

Press to start cooking programs.
Press to set express cooking program.

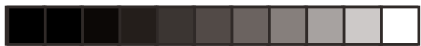

How to...

...use your microwave

Please note

Do not use metal pans or items with a metal handle or trim (including wire twist-ties) or melamine dishes (as they contain material that absorbs microwave energy and may cause dishes to crack or burn). All cookware should be suitable for microwave use and no containers with restricted openings (e.g. bottles) should be used. If baby bottles are heated, the teat should not be left on.

1. Slot the plug into the mains socket and switch the power on.

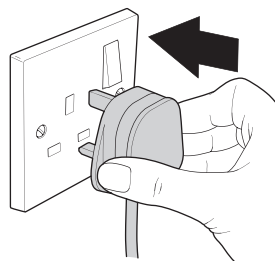

2. Place desired food to cook or defrost into a microwave-safe container, cover with a suitable cover (e.g. microwave-safe cling film).
Always pierce coverings with a fork to allow the steam to escape.
3. Pull the door handle to open the microwave door and place the food centrally on the glass plate in the microwave. Ensure multiple items are equally spaced.

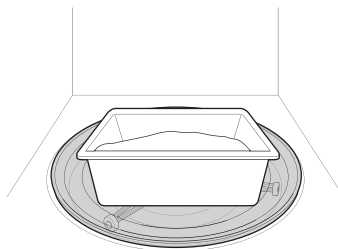

4. Close the door and choose the required menu/power level/time. Always check the food packaging for microwave guidelines specific to the product.

		
Potato	Popcorn	Pizza
		
Beverage	Frozen Dinner	Reheat
		
Clock	Time Cook	Kitchen Timer
		
Time Defrost	Weight Defrost	Power Level
1	2	3
4	5	6
7	8	9



5. After setting program, press the Start/+30 SEC. button to start cooking.

STOP
CANCEL
Hold 3 sec.

0

START
+30 SEC.

6. During cooking, if press STOP/CANCEL button once, the program will be paused, then press START/+30 SEC. button to resume. But if press STOP/CANCEL button twice, the program will be cancelled.

STOP
CANCEL
Hold 3 sec.

0

START
+30 SEC.

7. After the food has finished cooking the microwave will ding and turn off.

Leave the microwave for 30 seconds to 1 minute before opening the door, and removing the food with oven gloves.

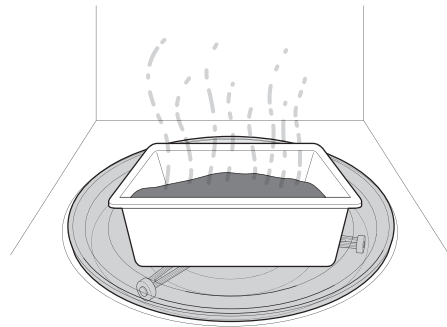



Setting Clock Time

This is a 12- or 24- hour clock, you can choose to set the clock time in 12- or 24- hour cycle by pressing CLOCK button in standby mode.

1. In standby mode, press CLOCK button once or twice to select 12- or 24- hour clock.
2. Use number buttons to set the correct time.
3. Press CLOCK or START/+30 SEC. button to confirm.

NOTE: During cooking, you can check the current clock time by pressing CLOCK button.

Express Cooking

Use this feature to program the oven to microwave food at 100% power conveniently. In standby mode, just press START/+30 SEC. button repeatedly to set cooking time (each press to increase 30 seconds, and up to 99 minutes and 99 seconds), the oven start cooking automatically at full power.

NOTE: During microwave cooking, you can add cooking time by pressing START/+30 SEC. button.



Microwave Cooking

1. In standby mode, press TIME COOK button once.
2. Use number buttons to set cooking time. The longest time is 99 minutes and 99 seconds.
3. Press POWER LEVEL button once (default 100% power level), and then use number buttons to set another power level.
4. Press START/+30 SEC. button to start.

Use number button to set power level:

Press number button	Power (Display)	Press number button	Power (Display)
1,0	100% (P100)	4	40% (P-40)
9	90% (P-90)	3	30% (P-30)
8	80% (P-80)	2	20% (P-20)
7	70% (P-70)	1	10% (P-10)
6	60% (P-60)	0	0% (P-00)
5	50% (P-50)		

NOTE: During cooking, you can press POWER LEVEL button to check cooking power.



Setting The Timer

1. In standby mode or during cooking, press KITCHEN TIMER button once.
2. Use number buttons to set desired time. The longest time is 99 minutes 99 seconds.
3. Press KITCHEN TIMER or START/+30 SEC. button to confirm.

NOTE: When the countdown ends, a "Beep" will sound to remind. You can check the countdown time by pressing KITCHEN TIMER button. If STOP/CANCEL button is pressed when the display screen shows the time, the function can be cancelled.

Multistage Cooking

Your oven can be programmed for up to 3 automatic cooking sequences. It can be composed of time defrost with one or two microwave cooking program, or composed of two microwave cooking program. Time defrost can only be set in the first stage.

- A. Time defrost with one or two-stage microwave cooking programs:
1. Open the door and place the food into the oven, close it.
 2. Press TIME DEFROST button once.
 3. Use number buttons to set defrosting time.



4. Input the first microwave cooking program. Do not press START/+30 SEC. button.

5. Input the second microwave cooking program.

6. Press START/+30 SEC. button to start.

NOTE: Step 5 is not necessary if you just need one microwave cooking program.

B. Two-stage microwave cooking programs:

Some recipes require different stages of cooking at different temperatures.

1. Input the first microwave cooking program. Do not press START/+30 SEC. button.

2. Input the second microwave cooking program.

3. Press START/+30 SEC. button to start.



Time Defrost

1. In standby mode, press TIME DEFROST button once.
2. Use number buttons to set defrosting time. The longest time is 99 minutes and 99 seconds.
3. Press START/+30 SEC. button to confirm.

NOTE: During defrosting, the system will pause and sound to remind user to turn food over, and then press START/+30 SEC. button to resume.

Defrost Profolio

Time(%)	Power(%)
1/4	60
1/4	40
Pause and Flipping	
1/4	30
1/4	20

Weight Defrost

The defrosting time and power level are automatically set once the food weight is programmed. The maximum frozen food weight is 2000 g.

1. In standby mode, press WEIGHT DEFROST button once.
2. Use number buttons to set food weight.
3. Press START/+30 SEC. button to confirm.

NOTE: During defrosting, the system will pause and sound to remind user to turn food over, and then press START/+30 SEC. button to resume.



Auto Cook Menus

For the following food or cooking mode, it is not necessary to program the cooking time and power. It is sufficient to indicate the type of food that you want to cook as well as the weight or servings of this food.

Popcorn

1. Press POPCORN once. Popcorn automatically sets the cooking time for a 99 g bag of microwave popcorn.
2. Press START/+30 SEC. button to start.

NOTE:

- 1) To change the preset time: Press POPCORN twice. Press number buttons to set minutes and seconds. Press START/+30 SEC. to start. The longest cooking time is 99 minutes and 99 seconds. This new cooking time will be set as the default one until next power on.
- 2) For a better cooking effect, when you cook popcorn, you need to fold the four corners of the package (As the figure below), then put it in the center of the microwave oven.



Potato

For potatoes (120-170 g/serving):

1. Press POTATO once.
2. Enter number of potatoes by pressing number buttons from 1 to 4.
3. Press START/+30 SEC. button to start.

For potatoes (220-280 g/serving):

1. Press POTATO twice.
2. Enter number of potatoes by pressing number buttons from 1 to 4.
3. Press START/+30 SEC. button to start.



Pizza

Reheating a slice of pizza (about 150 g):

1. Press PIZZA once.
2. Press START/+30 SEC. button to start.

Heating a whole frozen pizza (about 450 g):

1. Press PIZZA twice.
2. Press START/+30 SEC. button to start.

Frozen Dinner

For frozen dinners (200-250 g/serving):

1. Press FROZEN DINNER once.
2. For 1 entree, press number button "1". For 2 entrees, press number button "2".
3. Press START/+30 SEC. button.

For frozen dinners (280-340 g/serving):

1. Press FROZEN DINNER twice.
2. For 1 entree, press number button "1". For 2 entrees, press number button "2".
3. Press START/+30 SEC. button to start.

Beverage

For cups (150-200 ml/serving):

1. Press BEVERAGE once.
2. Enter number of cups by pressing number buttons from 1 to 4.
3. Press START/+30 SEC. button to start.

For cups (250-300 ml/serving):

1. Press BEVERAGE twice.
2. Enter number of mugs by pressing number buttons from 1 to 4.
3. Press START/+30 SEC. button to start.

Reheat

To reheat a plate of leftover (350-500 g):

1. Press REHEAT button once.
2. Press START/+30 SEC. button to start.



Child Lock

The safety lock prevents unsupervised operation by children.

To set: In standby mode, press and hold STOP/CANCEL button for 3 seconds, a "Beep" will sound and the display screen will show "Loc" for 5 seconds, the oven will auto enter child lock mode. In the lock state, all buttons are disabled.

To cancel: Press and hold STOP/CANCEL button for 3 seconds, a "Beep" will sound.





How to...

...clean your microwave

Make sure the microwave is disconnected from the power and is completely cool. Failure to keep the microwave clean can lead to deterioration in the interior that could affect the life of the appliance and result in a hazardous condition.

1. When food or liquids stick to the microwave walls wipe clean with a damp cloth (do not use harsh detergents or abrasives).
2. You can clean the outside of the oven with a damp cloth and dry with a soft dry cloth. Don't allow water to seep into the ventilation openings.
3. Wipe the door and window on both sides regularly along with the door seals and adjacent parts with a damp cloth to remove spills or spatters. Do not use abrasive cleaners.
4. The waveguide cover is on the right side of the oven - this is where microwave pass through to cook your food. **NEVER** use the microwave without the waveguide cover. If it is damage please contact the technical helpline for a replacement. It must be kept clean at all times by wiping with a mild detergent and water, then allowing to dry.
5. Do not allow the control panel to become wet. Clean with a damp cloth and dry thoroughly.
6. If steam builds inside or around the microwave door, wipe away with a damp cloth.
7. If the inside of the microwave smells, mix the juice and skin of a lemon with some water in a microwavable bowl. Place in the microwave and heat for 3 minutes on full power, then wipe the inside of the microwave thoroughly with a dry cloth.
8. Regularly clean the turntable support and oven floor by wiping the bottom of the oven with a mild detergent and water, then drying with a cloth. The turntable can be washed in warm soapy water, then dried thoroughly before placing back inside the microwave. Always make sure it is fitted back in correctly.



How to...

...solve common problems

Problem	What to do
If the microwave doesn't work.	<ol style="list-style-type: none">1. Ensure it is plugged in securely.2. Check the mains fuse has not been tripped (if it has, reset the fuse).3. See if another appliance works when plugged into the same socket (if it doesn't, the socket may be faulty).4. If the socket works, replace the fuse.
If the microwave will not heat food:	<ol style="list-style-type: none">1. Check the timer has not been set.2. Ensure the door is securely closed (as a safety feature, if the door is not fully shut the microwave will not operate).

Specifications

Rated voltage:	230-240V ~ 50Hz
Operating frequency:	2,450MHz
Power output:	700W
Outside capacity:	243mm(H)×446mm(W)×323mm(D)
Oven capacity:	17 Litres
Weight (Approx):	9.4kg
Standby mode:	0.6W



How to...

...change the fuse

1. Only use a 13 amp fuse.
2. To change the fuse, place a screwdriver into the recess of the plug cover and pull the fuse holder upward until it's free.
3. Slide the fuse out and pop in the replacement.
4. Slot the fuse holder back into the recess and push down until it locks into place.

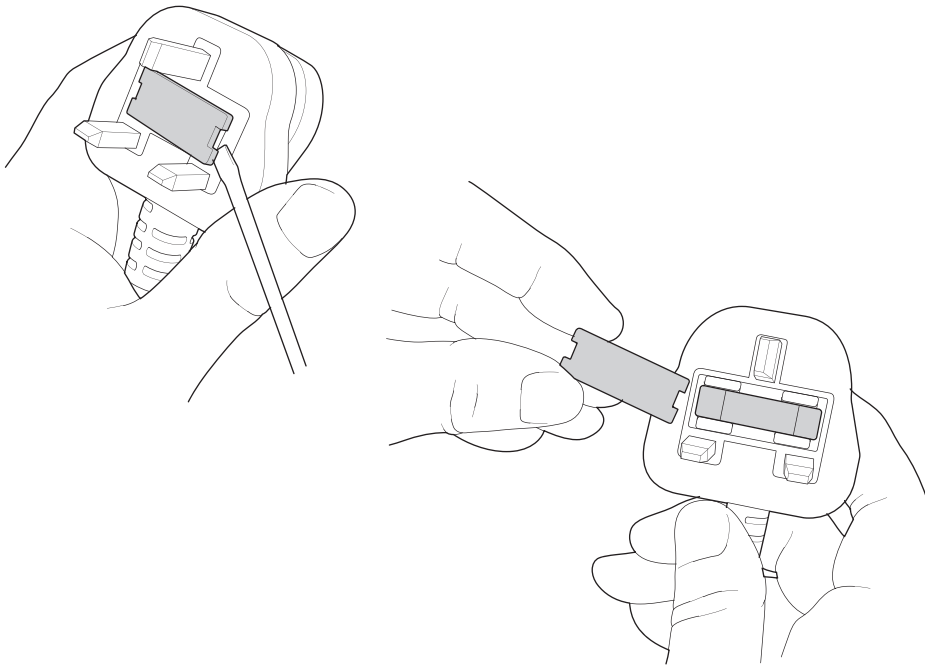



Notes...





If for any reason you're not completely satisfied with our product, return it within 100 days with your proof of purchase, and we'll give you an exchange or a refund.

UK Mainland stores only.

Excludes franchises.

The guarantee excludes flat pack furniture, which can't be returned if it has been partly or fully assembled unless faulty or mis-described.

Also excludes mattresses, which can't be returned for hygiene reasons once used, unless faulty or mis-described.

Need something else?

www.GEORGE.com

We have a wide range of accessories and other products that can be ordered direct to your door.

For PDF copy of this manual please scan QR code and search for model number

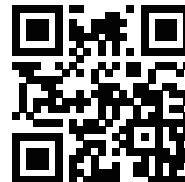

ASDA
technica support
0333 600 7 700

Customer services information

If you have any problems, need more information or spare parts, or even just some advice on your product, then don't hesitate to contact customer services at the telephone number or address shown opposite. N.B. When calling or writing please have your product site code handy.

Call

0800 952 0101

Write

ASDA, Leeds LS11 5AD.

Product name: **GHMON1171B5G/GHMON1171W5G/
GHMON1171S5G
17L Digital microwave oven**

Product site code: **15A.06.25.106/15A.06.25.107/
15A.06.25.108**



To qualify for the 2 year warranty the appliance must have been used according to the manufacturer's instructions. For example kettles should have been regularly de-scaled.

If your appliance stops working or develops a fault then return it to your nearest store and we will happily replace or refund the item, with exception of the below exclusions:

EXCLUSIONS

ASDA shall not be liable to replace goods under the terms of the warranty where:

1. The fault has been caused or is attributable to accidental use, misuse, negligent use or use contrary to the user manual's recommendations or where the fault has been caused by power surges or damage caused in transit.
2. The appliance has been used on a voltage supply other than that described on the product rating label.
3. Repairs have been attempted by persons other than our service staff (or authorised dealer).
4. Where the appliance has been used for hire purposes or non-domestic use.
5. ASDA are not liable to carry out any type of servicing work, under the warranty.

This warranty does not confer any rights other than those expressly set out above and does not cover any claims for consequential loss or damage. This warranty is offered as an additional benefit and does not affect your statutory rights as a consumer.

If for any reason this item is replaced during the 2 year warranty period, the warranty on the new item will be calculated from original purchase date. It is vital to retain your original proof of purchase to indicate the date of initial purchase.

Copyright

© 2025 ASDA Stores Limited.
All other trademarks appearing herein are the property of their representative owners.
Specifications are subject to change without notice.

Manufactured for:

ASDA, Leeds LS11 5AD/
ASDA, Antrim BT41 4GY.

Disposal

This symbol on the product or in the instructions means that your electrical and electronic equipment should be disposed at the end of its life separately from your household waste. There are separate collection systems for recycling in the UK.

For more information, please contact the local authority or your retailer where you purchased the product.

